

Garden Areas -

Plot 1 - 58.1m ² (5P3B)
Plot 2 - 60.7m ² (5P3B)
Plot 3 - 59.0m ² (4P2B)
Plot 4 - 52.7m ² (4P2B)
Plot 5 - 52.4m ² (4P2B)
Plot 6 - 49.8m ² (4P2B)
Plot 7 - 28.2m ² (2P1B)
Plot 8 - 24.2m ² (2P1B)
Plot 9 - 24.2m ² (2P1B)
Plot 10 - 28.2m ² (2P1B)
Plot 11 - 50.5m ² (4P2B)
Plot 12 - 56.2m ² (4P2B)
Plot 13 - 54.4m ² (5P3B)
Plot 14 - 59.9m ² (5P3B)
Plot 15 - 81.7m ² (4P2B)
Plot 16 - 37.1m ² (4P2B)
Plot 17 - 59.4m ² (4P2B)
Plot 18 - 37.6m ² (2P1B)
Plot 19 - 51.0m ² (2P1B)
Plot 20 - 37.6m ² (2P1B)
Plot 21 - 66.5m ² (2P1B)
Plot 22 - 120.2m ² (4P2B)
Plot 23 - 102.6m ² (4P2B)
Plot 24 - 54.4m ² (2P1B)
Plot 25 - 29.1m ² (2P1B)
Plot 26 - 40.0m ² (2P1B)
Plot 27 - 50.9m ² (2P1B)
Plot 28 - 91.1m ² (6P4B)
Plot 29 - 86.5m ² (6P4B)
Plot 30 - 66.1m ² (5P3B)
Plot 31 - 66.1m ² (5P3B)
Plot 32 - 34.1m ² (2P1B)
Plot 33 - 60.9m ² (2P1B)
Plot 34 - 32.9m ² (2P1B)
Plot 35 - 63.2m ² (2P1B)

Key/Legend:

- - Indicates Application Site Boundary
- - Close Board Timber Boundary Fence; 1.8m high
- - Low Level Post & Rail Fencing
- - Low Level Timber Knee Rail Fencing
- Retaining Wall - See Engineers Drawings

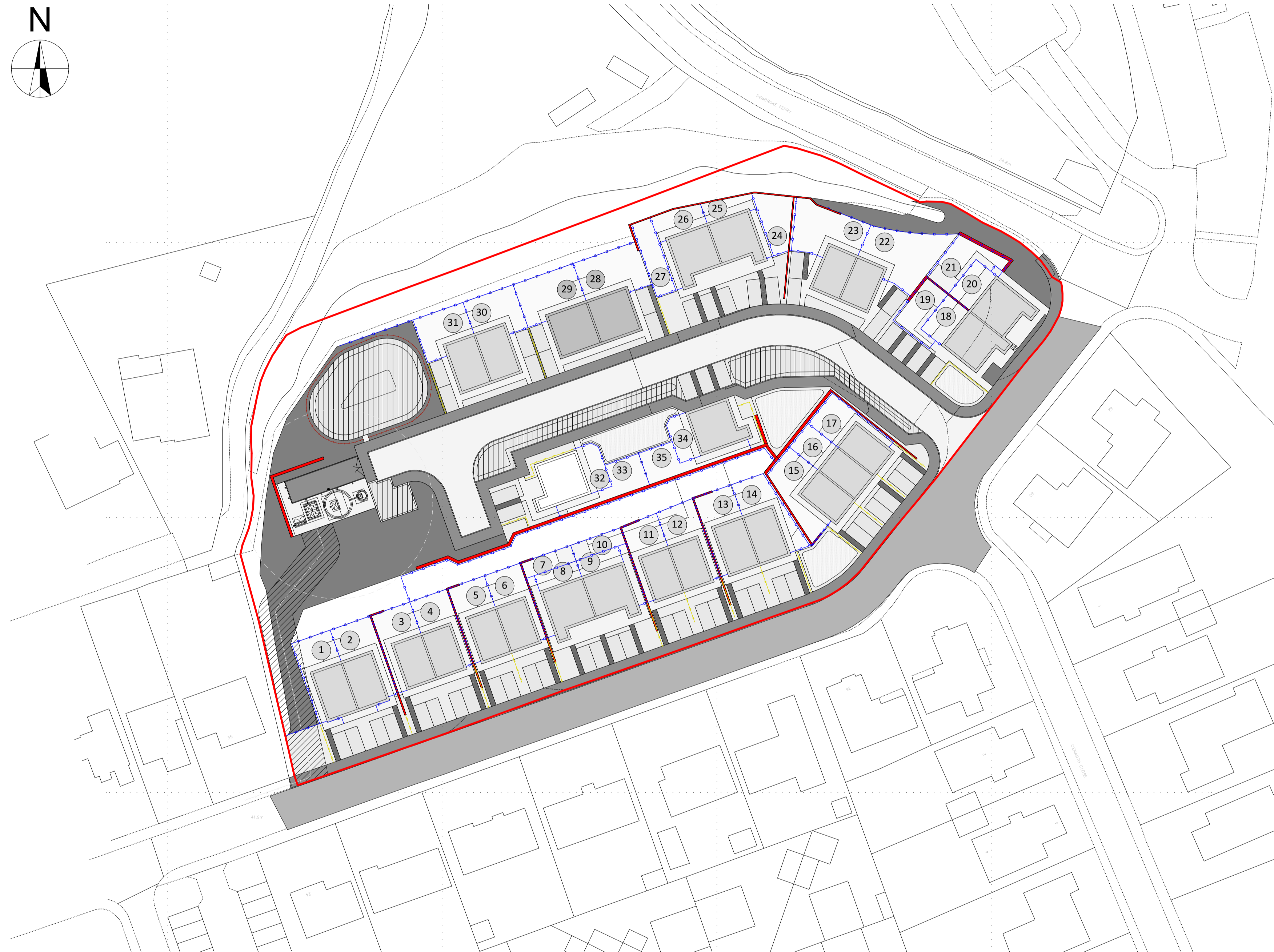

Proposed Site Plan

1:500

Revision:	Date:	By:

Notes:

- To be read in conjunction with 'proposed external house type finishes site plan' dwg. no. R594 P-07 for individual plot finishes.
- To be read in conjunction with 'proposed house type external finishes drawing' dwg. no. R594 P-08.
- To be read in conjunction with landscaping plan by Tir Collective.
- To be read in conjunction with Ecological Appraisal Report by I&G Ecological Consulting
- For highway, footpaths, shared surfaces & parking bay finishes to be read in conjunction with engineer's drawings



Client:
Castell Group

Scale: Noted
Date: Aug '24
Drawn: SE/RH

Job Title:
Proposed Residential Development at Former Cleddau Bridge Hotel, Pembroke Dock, SA72 6HZ

Drawing Title:
PLANNING DRAWINGS - Boundary Treatment Plan

R594 P-03