

Proposed First Floor- 1:100

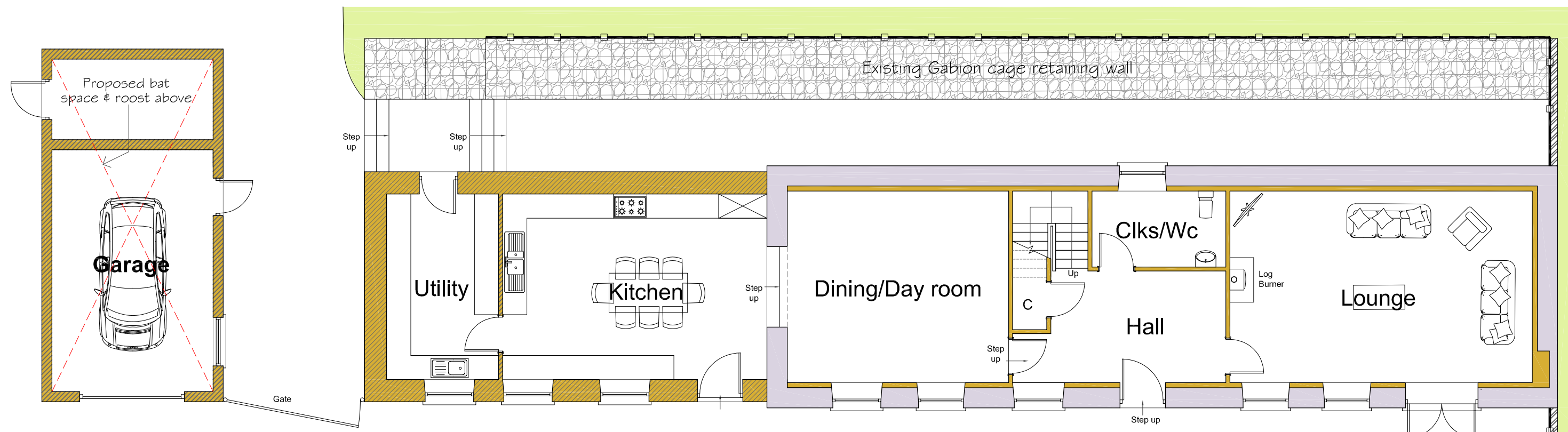

Proposed Ground Floor - 1:100

**FLOOR AREAS -**  
 Existing Total Ground floor = 142sqm  
 Existing Total First floor = 93sqm  
 Existing Total Floor area = 235sqm  
 (Extg side extension to be demolished) = 49sqm  
 New replacement side extension = 44sqm  
 New detached garage incl. bat roost = 33sqm  
 Proposed Total Floor area = 263sqm  
 Note-All areas are usable internal floor areas)

Revision	Description	Date
Drawing <b>PROPOSED FLOOR LAYOUTS</b>		
Clients <b>Hean Castle Estate</b>		
Project / title Rowston Caravan Park - Major Application - Upgrade/exchange of tents and statics to new 225 statics plus Conversion of Barn to Managers Dwelling with removal of Modern sheds plus new detached garage.		
Drawing Number <b>P08</b>	Revision	Scale 1:100
		Date OCT 2022

**Hayston Developments & Planning Ltd**  
 The Planning Studio, Hayston Bridge  
 Johnston, Haverfordwest  
 Pembrokeshire SA62 3HJ  
 01437 891 817  
 07515 851 704  
 andrew@haystonplanning.co.uk  
 www.planningpembrokeshire.co.uk



# PROPOSED FLOOR PLANS